

**MATERIAL**

Stainless steel, matte finish.

AISI 304 stainless steel screw and nut.

Polyamide based (PA) or polytetrafluoroethylene based (PTFE) technopolymer sliding bushing.

**FEATURES AND APPLICATIONS**

GN 145.1-NI connecting clamps can normally be matched with the linear actuators.

By clamping the guide hole d1 it is possible to adjust the actuator positioning and to lock the slider after having set up the final position. The clamping screws d3 may be replaced by clamping kits GN 911 (see page 1958).

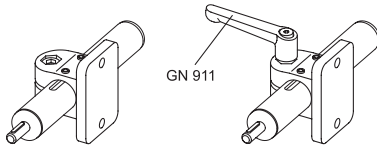

- 1
- 2
- 3
- 4
- 5
- 6
- 7
- 8
- 9
- 10
- 11
- 12
- 13
- 14
- 15
- 16
- 17
- 18

Conversion Table 1 mm = 0.039 inch	
d1	
mm	inch
18	0.71

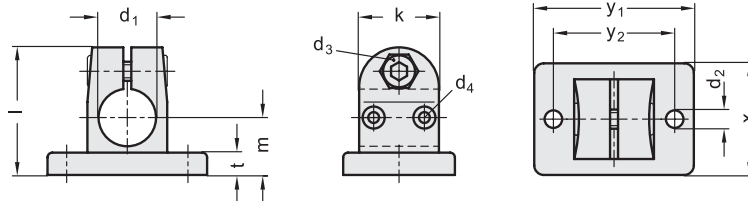

INOX STAINLESS STEEL METRIC

Code	Description	d1##	d2	d3	d4	k	l	m	t	x	y1	y2	d3 Clamping kit	⚖️
GN.45713	GN 145.1-G18-2-NI	18	5.5	M6	M3	25	40	18	7	35	50	38	GN 911-M6-22	145

## Hole with sliding bushing.